

Title:
Carmacks Flood Mapping Study
Composite Flood Hazard Extents
5% Annual Exceedance Probability (AEP)

Client/Project:

Government of Yukon
 Department of Environment
 Water Resources Branch

Project: 12322320

Project Location:
 Carmacks, Yukon

Prepared by MANDERSON on 2024-05-21
 Requested by JMUJIRHEAD on 2024-01-07
 Review by JMUJIRHEAD on 2024-05-21

- | | |
|---|--|
| Flow Direction | Hydraulic Model Cross-Sections |
| Point of Interest | Inundation under Modelled Ice Jam Runs |
| Bridge | Inundation under Modelled Open Water Runs |
| Highway | Composite Flood Hazard Extent |
| Local Road | Ice Jam Location (toe of jam) |
| Little Salmon / Carmacks First Nation Settlement Land | 50 % AEP Extent |
| Land Parcels | Hydraulic Model Cross-Sections |
| Municipal Boundary | Cross-Section Number
WSE (m) in Main Channel of Cross-Section |
| Study Area | |

Map Publication Date: May 21, 2024
 0 40 80 120 160 200
 m
 (At original document size of 11x 17) 1:5,000

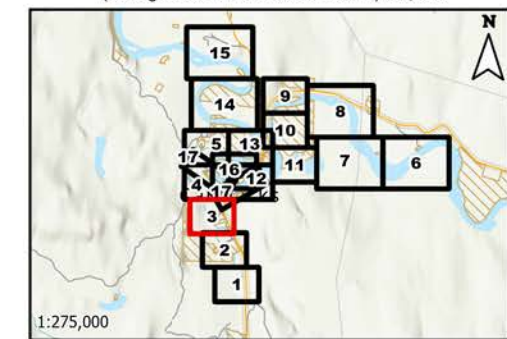

- Notes**
1. Coordinate System: NAD 1983 UTM Zone 8N
Vertical Datum: CGVD2013, Geoid: CGG2013a
 2. Data Sources: GeoYukon, Canada Lands Survey (CLS) CCM 982, Canvec.
 3. Background: World Topographic Map: Northwest Territories, State of Alaska, Esri Canada, Esri, TomTom, Garmin, SafeGraph, METI/NASA, USGS, EPA, NPS, USDA, NRCan, Parks Canada World Hillshade: Esri, USGS
 4. Flood hazard extents shown on these maps are based on LIDAR collected on June 8 - 10 of 2019, and bathymetric/topographic survey collected in July and August of 2023.

